

**NOTES:**

1. WALL MOUNT BRACKET SHIPPED LOOSE. BRACKET MUST BE ATTACHED TO WALL USING FIELD-SUPPLIED HARDWARE.

2. UNIT MOUNT BRACKET TO BE WELDED TO DATA COOL UNIT BY DATA AIRE.

REVISIONS				
REV	DESCRIPTION	DATE	BY	CHKBY
A	UPDATED TITLE BLOCK AND DRAWING NOTATIONS	04-21-16	JAP	GM

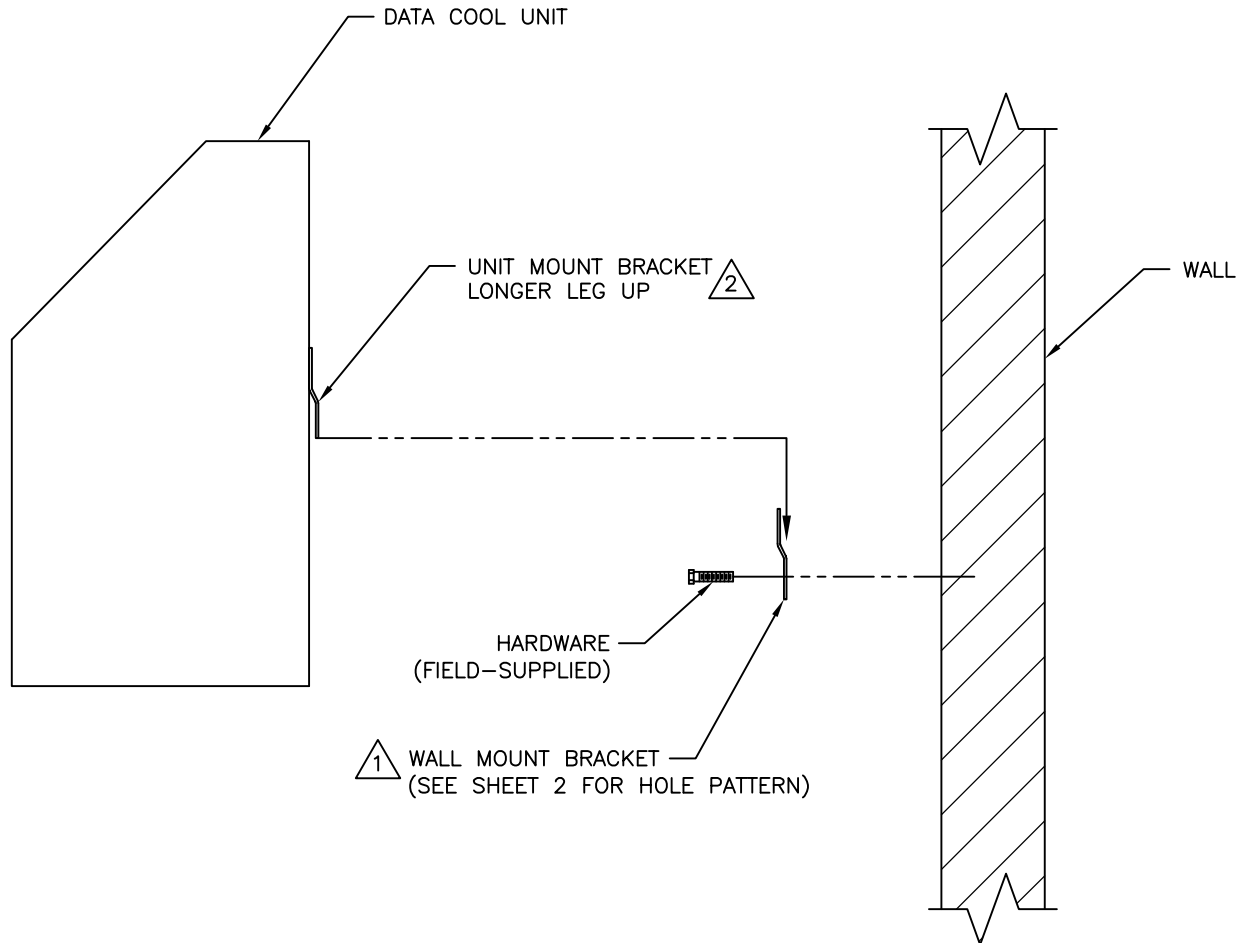

ASSEMBLY, WALL AND UNIT MOUNT BRACKET			
<b>dataaire</b>			
DRAWN BY : J. PATTON		SCALE: NONE	
CHECKED BY :		SH 1 OF 2	
DATE :	11-11-2010	REV	A
PART OF			
557-721-001			
DWG NO.			

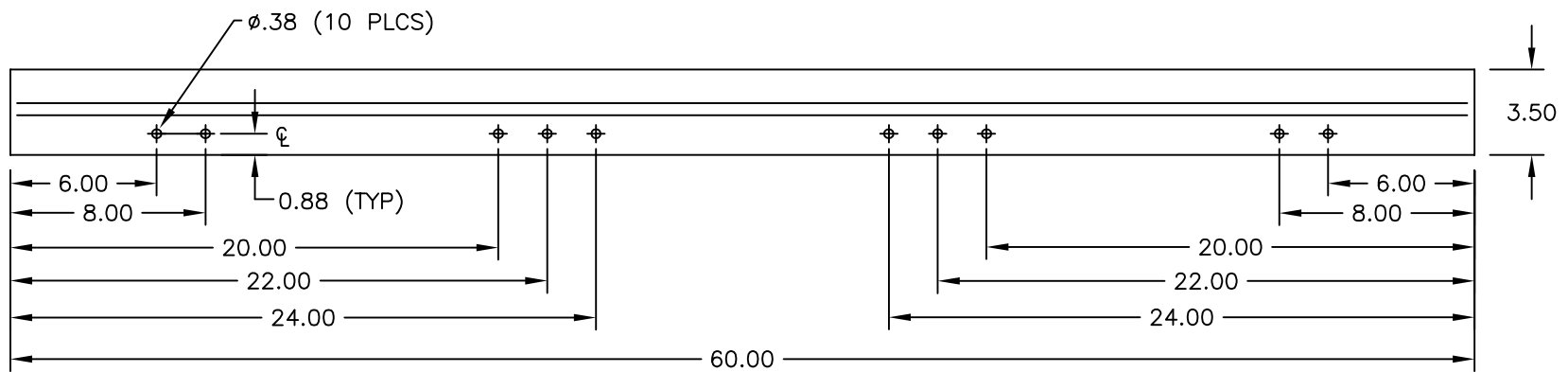

**WALL MOUNT BRACKET**  
**(HOLE PATTERN)**

ASSEMBLY, WALL AND UNIT MOUNT BRACKET			
<b>dataaire</b>			
DRAWN BY : J. PATTON		SCALE: NONE	
CHECKED BY :		SH 2 OF 2	
DATE :	11-11-2010	REV	A
PART OF			
<b>557-721-001</b>			
DWG NO.			